

USB Auto-Load Functionality

The miniBox has the ability to automatically update its contents using any USB drive. This feature also supports password security to prevent unauthorized tampering with the device.

Notes:

Firmware version 1.5.5.b16 or later is required for this feature.

Size of USB drive cannot exceed the size of the CompactFlash card.

USB drive must be formatted in FAT or FAT32. NTFS-formatted drives will not work.

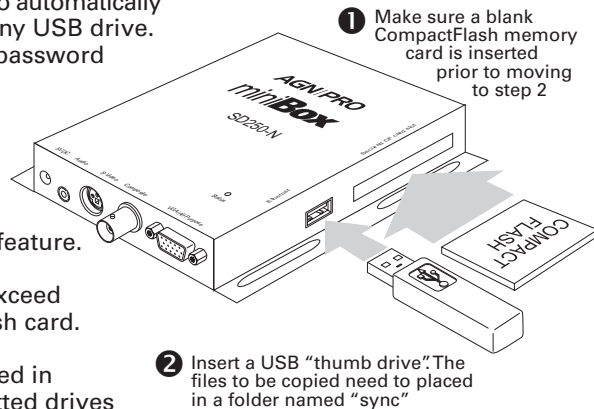

How to Use Auto-Load

1. Create a folder named "'sync'" on your USB drive. Note that the "sync" folder cannot be stored within another folder on the drive. It must be on the "root" of the drive
2. Copy your media files and playlist (optional) into the sync folder. Filenames must not contain spaces or special characters.
3. With CompactFlash memory card already inserted, plug the USB drive into the miniBox USB port
4. You will see progress indicated on the screen as each file is uploaded.

Advanced Functionality

Password Protection

1. Create a file named "'password.txt"'.
2. Type your password into the file
3. Copy the password.txt file to both the CompactFlash card and USB drive. Note: Do not copy the password.txt file into a folder. It must be placed in the "root" of each device.
4. When the CompactFlash card has a password.txt file on it, only those USB drives that have same password.txt file can update this device

Retrieving media playback logs

1. Edit a PLAYLIST file.
2. In a playlist section (PL), insert the command "<<STORE:LOG>>".
3. Perform the Auto-Load procedure.
4. When the update process is completed, the media play records will be stored in folder called "log" on the USB drive.

Example of the command in a playlist:

```
[PL1:start]
<<STORE:LOG>>
<<VIDEO:ON>>
<video1.mpg>
<video2.mpg>
^[PL1]
```

AGN|PRO miniBox SD150

Quick Setup Guide

STEP 1: Hardware Setup & Installation



2. Connect the display via VGA, composite or S-Video. Connect audio if desired

* Use included DB-6 Mini-DIN/DB-9 cable with serial port

3. Adjust the switches on the back panel for your chosen video output. For composite and S-Video, choose "TV". (N. America, Japan, S. Korea, choose "NTSC". Europe, Asia, Australia, choose "PAL")

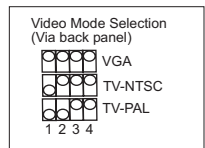

STEP 2: Set the Clock

To set the internal clock, use an object such as a pen to press and hold down the small button located on the back of the unit. The date and time will appear on screen. Set the date and time numbers by using short presses on the button, and move to the next digit by holding down the button. When you get to the last digit (seconds), hold the button down until you see "OK" on screen.

STEP 3: Play Media

Copy media files from your PC to a CompactFlash memory card using a card reader. Transfer the memory card to your media processor. Alternatively, you can use the USB auto-load function. See other side for information.

Files will play in a loop in the alphabetical order of the filenames

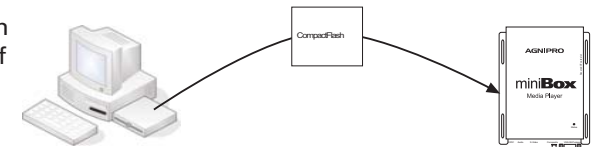

You can schedule media playback using a playlist that you can create in any text editor. Just copy the playlist with its associated media files on the CompactFlash card.